

VEKARail™
Guard Rail System
INSTALLATION MANUAL

VEKARail™
Guard Rail System

100 Veka Drive
Fombell, PA 16123

1.888.GO4.VEKA
www.vekadeck.com
www.vekainnovations.com



VEKA Innovations



VEKA
Rail™
Guard Rail System



VEKA Innovations™ WARRANTY

VEKA Innovations warrants their rigid vinyl extrusions to be the finest quality available and to be superior for exterior fencing applications. VEKA Innovations warrants that their rigid vinyl extrusions will not chip, peel, blister, rot or corrode when used in accordance with VEKA Innovations installation, care & maintenance instructions.

VEKA Innovations does not warrant against uniform fading or color change due to normal weather conditions, as normal weathering will cause any surface to gradually fade or darken. This warranty is for a period of 20 years from the date of manufacture. Should any defective material be found during the warranty period, VEKA Innovations will replace the defective material free of charge.

This warranty does not cover liability for incidental or consequential damages for any cause whatsoever.

THIS WARRANTY IS IN LIEU OF ALL OTHER WARRANTIES, EXPRESSED OR IMPLIED, INCLUDING WARRANTIES OF MERCHANT ABILITY AND FITNESS FOR A PARTICULAR USE



VEKARAIL ACCESSORIES

Post Cap Options



4" Gothic



4" Dome



4" Horse Cap



4" New England

Stair Options

VEKA Innovations offers a variety of stair options, which are available in 4', 6' and 8' lengths on center.

Rail Options

Available in 36" and 42" heights

Available in 6', 8' and 10' lengths

Available in white, almond or khaki vinyl



H-Channel aluminum reinforcement included in 6', 8' and 10' lengths.



TABLE of CONTENTS

<i>Properties and Building Materials.....</i>	<i>1</i>
<i>Quality Assurance.....</i>	<i>2</i>
<i>Preparation and Post Installation.....</i>	<i>3</i>
<i>Cleaning.....</i>	<i>4</i>
<i>Top & Bottom Rail Installation.....</i>	<i>5-6</i>
<i>Accessories.....</i>	<i>7</i>
<i>Warranty.....</i>	<i>8</i>



VEKARail™ PROPERTIES

The contractor shall provide a complete, PVC guard rail system of the design, style and strength defined herein. Guard rail components consist of profiles made of extruded, rigid PVC. This PVC material is specially formulated for outdoor use with superior fade and impact resistant properties. The system shall include all posts, rails, balusters, caps, reinforcing, and accessory items necessary to complete the installation.

The product formulation is not only fade resistant, but does not absorb water or oil; therefore, avoiding staining issues often associated with composite products. VEKARail™ is impervious to salt water and chlorine, making it an excellent choice for marine and swimming pool uses. The heat absorption rate for the three available colors (khaki, almond, white,) is extremely low, as tested in accordance with the ASTM D4803 standard (relating to heat build up) for North America.

VEKARail™ MATERIALS

General: Provide PVC Guard rail materials recognized to be of type indicated and tested to show compliance with indicated performances.

Manufacturer: Subject to compliance with requirements, manufacturers offering products that may be incorporated in the work include:

1. Veka Innovations- 100 Veka Drive Fombell PA 16123.
2. Veka Innovations- 427 Thatcher Lane Youngstown OH 44515

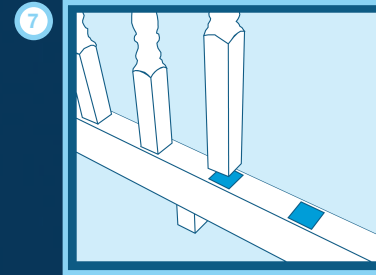

7 If needed cut the balusters to the desired height. Install each baluster into each routed hole in the bottom rail.

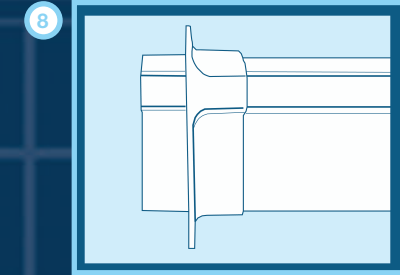

8 Slide brackets onto the top rail.

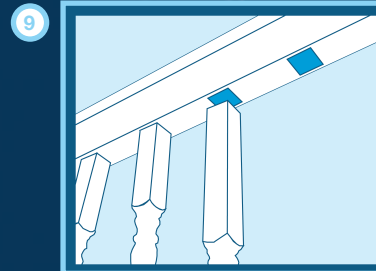

9 Insert balusters into routed holes in the top rail starting at one end and working your way to the opposite end. Installing one baluster at a time, allow the rail to drop down onto the baluster.

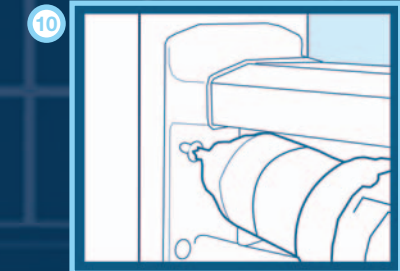

10 Establish the height of the top rail. Make sure that the top rail is level, plumb and square. Fasten brackets to post by screwing through the brackets into the vinyl sleeved posts using self-tapping screws.

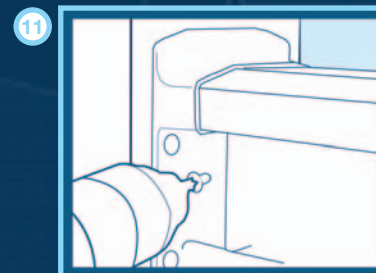

11 Once the top and bottom rails are both in place fasten them to the brackets by screwing through each side of the brackets into the sides of the rail.

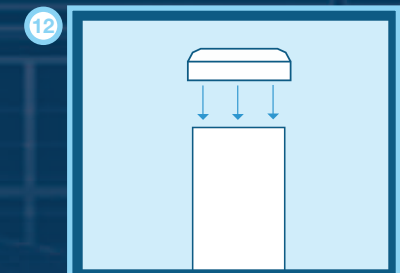

12 Place post cap onto post.



Top and Bottom Rail Installation

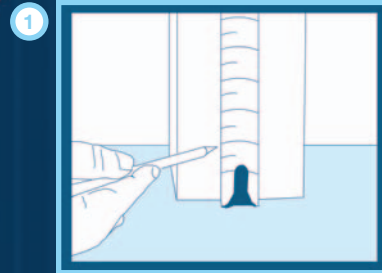

1 Determine the level placement of the bottom rail making sure that there is no greater than a 2" space from the bottom of the rail to the top of the standing level surface. At this point mark the mounting surface using a pencil.

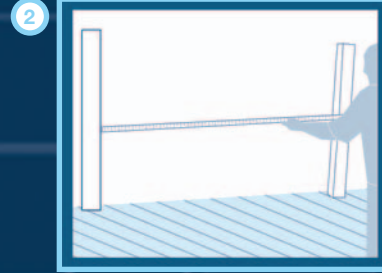

2 Measure the opening at the location where the bottom rail is to be installed.

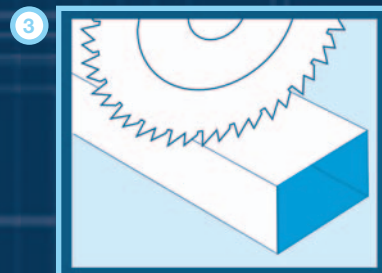

3 When trimming for installation, cut an even amount of material from each side. The aluminum insert and the vinyl rail should be cut to the same length. You can either cut both the aluminum and vinyl at the same time or individually.

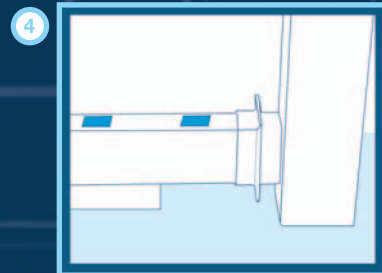

4 Slide brackets onto bottom rail. Position rail at required height. Note: It is helpful to use a spacer to support rail at proper height.

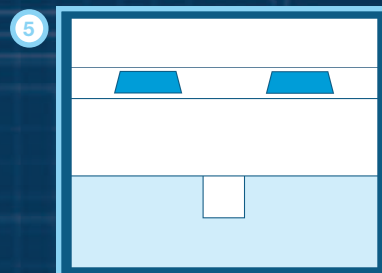

5 Add center support to the underside of the bottom rail.

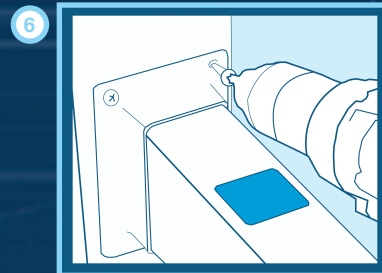

6 Slide the bottom rail into place making sure that the rail is plumb, square, and level (with the exception of a stair railing section). Fasten brackets to post by screwing through the brackets into the vinyl sleeved posts using self-tapping screws.

VEKARail™ QUALITY ASSURANCE

VEKARail™ is tested and evaluated and meets or exceeds all testing criteria which is required in most states for proper materials and installation. This means VEKARail™ is a safe and reliable product, providing many years of service. (See ICC-ES evaluation report ESR-1850 at www.icc-es.org)

PVC Guard Rail Fabricator/Installer Qualifications: Engage a VEKA approved fabricator to ensure successful completion of project.

Obtain PVC Guard rail accessories, fittings and fasteners from a VEKA approved source to ensure consistent quality standards are maintained throughout the project.

Manufacturer Qualifications: Manufacturer should be capable of providing field service representation during construction and should be capable of approving acceptable installer and application methods.

To assure a quality product with years of useful service, VEKA maintains its own 3-tier quality assurance program.



PREPARATION

Verify deck and concrete conditions to be sure that they are acceptable for product installation in accordance with that manufacturer's instructions.

The contractor in accordance with the construction plans shall layout all new installations.

GUARD RAIL INSTALLATION

General Installation

- Check all local building codes for design load requirements for railing application. Always use safety equipment during installation.
- During installation, the PVC components shall be handled carefully and stored to avoid contact with any abrasive surfaces.
- Any variation from the installation must be approved by the manufacturer.
- The cost for removal and/or replacement of material from the result of a variation will be the contractor's responsibility.

POST INSTALLATION

- Attach wood post to concrete surface or wood deck using proper hardware and follow all recommended manufacturer installation instructions at positions indicated on the drawings.
- Posts should extend at least 24" above deck surface to ensure proper support.
- Cover posts with vinyl post sleeves in one piece, plumb, square, and in line.
- Maximum spacing for posts should be 10 feet from the inside of the first post to the inside of the second post unless otherwise specified.

CLEANING VEKARAIL

- Wash using a soft cloth or ordinary long-handled soft bristle brush.
- For difficult to remove dirt and stains such as top soil, motor oil, lithium grease, etc. use the readily available household cleaners such as:

Fantastic™

Murphy's oil soap™

Lestoil™

Lysol™

Windex™

Vinegar and water

Soft Scrub™

- In some cases you may wish to use mildly abrasive cleaner, such as cleanser or a paste-like scrubbing solution. Use of abrasive material could have a negative effect on the surface of the fence.
- Do not use cleaners containing aggressive organic solvents because they could affect the surface appearance of the vinyl. Examples of such cleaners are as follows: chlorine bleach, liquid grease remover, strong soaps, and detergents containing organic solvents, nail polish remover, and furniture polish/cleaners.